

FORT KNOX

SAFES  VAULTS



2025 BUYING GUIDE & CATALOG



Fort Knox was founded in the year 1982 by Tom James, with a mission to protect firearms from unwanted hands. To this day, we remain family owned and operated, expanding our commitment to safeguard not just firearms, but also cherished memories, heirlooms, and valuables. This journey has solidified our position as the gold standard in security, with a dedication to American quality, ingenuity, and integrity.

Today, over four decades later, our unwavering commitment to protecting your legacy echoes the enduring spirit of our founder and the principles that have guided us from the beginning.

TABLE OF CONTENTS

BUYING GUIDE

SIZE OPTIONS	4
BODY STEEL THICKNESS	6
DOOR STEEL THICKNESS	7
FIRE PROTECTION	8
UPGRADES	11
EXTERIOR COLOR	12
LOCKS & GRAPHICS	13
INTERIORS	14
ACCESSORIES	16
SECURITY BOXES	17

PRODUCT CATALOG

SPARTAN & MAVERICK	20
DEFENDER & PROTECTOR	21
EXECUTIVE & GUARDIAN	22
TITAN & LEGEND	23
HOME SAFES	24
VAULT DOORS	24
VAULT DOOR FAQ'S	25
COMPARISON TABLE	26



01. SIZE OPTIONS

Consider the following questions to ensure you get the most out of your Fort Knox Safe

How Do I Choose the Right Size?

Evaluate the size, shape, volume, and nature of your valuables, as these factors will significantly influence the size and interior configuration of your safe. Consider the number of firearms you own and anticipate the future growth of your collection by selecting a safe larger than your current needs. This will ensure space for your expanding collection.

Organize and preserve your collection with our modular interior configurations designed to suit your unique requirements. Including shelves, gun racks, door organizers and jewelry cabinets. See Interior Configurations on pg. 14

Where Will the Safe Be Installed?

Measure your intended destination and delivery pathway, including door frames, narrow hallways, and tight corners to ensure your safe will fit. Internal, external, left, or right hinges are available to better accommodate your space. We recommend anchoring your safe down for added safety and security.

What Are the Limitations on Delivery?

Limitations such as ceiling height, stairs, stair-landings, turns, and the size/weight of the safe can make some installations difficult. If you have any questions about delivery or install, please contact Fort Knox.

VAULT DOOR: SIZE COMPARISON

New for 2025: Two Sizes to Accommodate Taller Door Frames



SAFE: SIZE COMPARISON

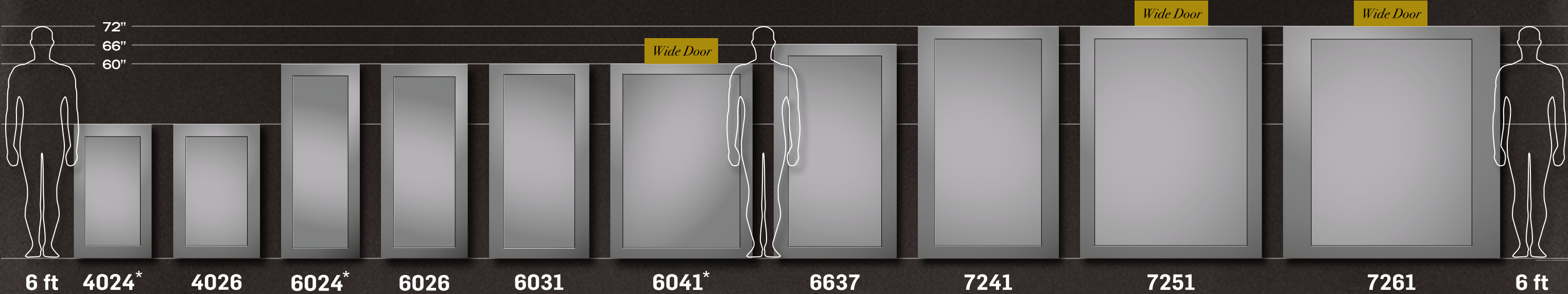

* MAVERICK EXCLUSIVE SIZE



02. BODY STEEL THICKNESS

Every Fort Knox product is proudly crafted in the USA using thick, high-quality American steel.

What Makes the Construction of Fort Knox Safes Different?

Fort Knox safes and vault doors begin as thick sheets of metal that are machine folded to minimize joints; remaining seams are welded both internally and externally for 100% weld penetration, creating a seamless, durable, solid steel enclosure.

What is Overall Steel Body Thickness?

The combined thickness of the outer steel body and the inner steel liners determine a safe's overall body thickness. For example, the Titan consists of a 3/16" steel body and a 3/16" ArmaKnox AR500 Package

resulting in a combined thickness of 3/8".
Refer to the chart below for a comprehensive breakdown of the overall steel body thickness in our safes.

Can I Upgrade My Steel Thickness?

Yes, maximize your security by adding up to 1/2" of layered protection with torch-resistant stainless, 7ga ballistic ArmaKnox AR500, or up to four layers of 10ga carbon steel. Mix and match to create the ultimate defense.

Upgrade details available on page 11.

MODEL:	SPARTAN	MAVERICK	DEFENDER	PROTECTOR	EXECUTIVE	GUARDIAN	TITAN	LEGEND	HOME SAFE	IN-SWING FRAME	OUT-SWING FRAME
INNER LINER	UPGRADE AVAILABLE	UPGRADE AVAILABLE	UPGRADE AVAILABLE	UPGRADE AVAILABLE	UPGRADE AVAILABLE	10GA LINER	AR500	AR500 STAINLESS	UPGRADE AVAILABLE	UPGRADE AVAILABLE	UPGRADE AVAILABLE
BODY STEEL	3/16"	10 GA	10 GA	3/16"	1/4"	3/16"	3/16"	3/16"	3/16"	3/16"	3/16"
OVERALL STEEL BODY THICKNESS	3/16"	10 GA	10 GA	3/16"	1/4"	5/16"	3/8"	1/2"	3/16"	3/16"	3/16"

* Fire-protection not shown in graph

03. DOOR STEEL THICKNESS

What is Door Edge Thickness?

Door Edge Thickness is found by combining the security door plate(s) thickness with the thickness of the door jacket.

What is a Hard Plate?

The **Hard Plate or Mounting Plate** is a ball-bearing reinforced, hardened steel plate that protects your lock and Relocker from cutting and drilling attacks.

What are Multiple Relockers?

Multiple Relockers are a defensive mechanism that will activate if an intruder attempts to cut the door, rendering it inoperable, keeping intruders out.

Why is The Security Plate Important?

The security plate, or door plate, is a heavy sheet of steel welded inside the 10ga door jacket. The plate fully covers the door face, it adds strength, security, and protects the door's integrity in the event of fire or forced entry.

Refer to the chart below for a comprehensive breakdown of our doors composition.

Can I Upgrade My Security Plates?

You can increase the number of plates and thickness of steel used in your safe door, including Carbon steel, Stainless steel, and ArmaKnox AR500.

Upgrades and Inner Steel Liners can be found on pg. 11

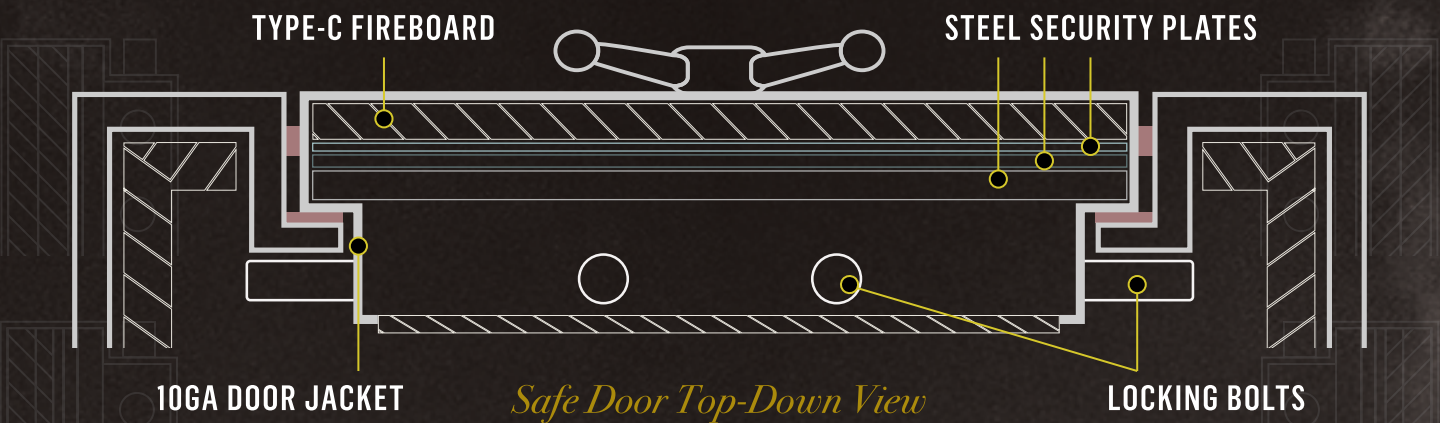

MODEL:	SPARTAN	MAVERICK	DEFENDER	PROTECTOR	EXECUTIVE	GUARDIAN	TITAN	LEGEND	HOME SAFE	VAULT DOOR IN-SWING	VAULT DOOR OUT-SWING
DOOR SECURITY PLATE	N/A	UPGRADE AVAILABLE 11GA	UPGRADE AVAILABLE 1/4" PLATE	UPGRADE AVAILABLE 1/4" PLATE	UPGRADE AVAILABLE 3/8" PLATE	UPGRADE AVAILABLE 3/8" PLATE	1/2" PLATE AR500 AR500	1/2" PLATE AR500 STAINLESS	UPGRADE AVAILABLE 1/4" PLATE	UPGRADE AVAILABLE 3/8" PLATE	UPGRADE AVAILABLE 3/8" PLATE
DOOR JACKET	3/8"	10 GA	10 GA	10 GA	10 GA	10 GA	10 GA	10 GA	10 GA	10 GA	10 GA
DOOR EDGE STEEL THICKNESS	3/8"	3/8"	1/2"	1/2"	5/8"	5/8"	3/4"	1"	1/2"	5/8"	5/8"

* Fire-protection not shown in graph

04. FIRE PROTECTION

Rest Assured Knowing our Robust Fire-Protection System Fortifies Your Fort Knox Safe.

How's Fort Knox Fire Protection Different?

At Fort Knox, our commitment to crafting top-tier fire protection sets us apart. Here's how we achieve it:

- Type-C Fireboard
- Palusol Fire Seal
- Thermal Barrier
- Security Plate
- Welded Anchors
- Thicker Steel
- Smoke Seal
- Solid Welded Seams

For a comprehensive breakdown see page 9

How Much Fire Protection Do I Need?

Consider the following when selecting your safes fire protection: The average house fire can exceed temperatures of 1,500°F and can burn for more than an hour. We offer fire protection up to 1,680°F in 90 minutes. For increased fire protection, choose a model with a 2 hour fire rating or upgrade with a Reinforced Fire Liner for the same protection.

RFL is not available on Spartan or Maverick models.

MODEL:	SPARTAN	MAVERICK	DEFENDER	PROTECTOR	EXECUTIVE	GUARDIAN	TITAN	LEGEND	HOME SAFE	VAULT DOOR IN-SWING	VAULT DOOR OUT-SWING
FIRE RATING	1,200° F In 60 Min	1,200° F In 75 Min	1,680° F In 90 Min	1,680° F In 90 Min	1,680° F In 90 Min	1,680° F In 90 Min	1,680° F In 90 Min	1,680° F In 90 Min	1,680° F In 120 Min	N/A	N/A

Add a Reinforced-Fire-Liner (RFL) for up to 2hr Protection! Not available on all models, More Info On Page 11

FIRE TEST: UP TO 1680° IN 90 MINUTES

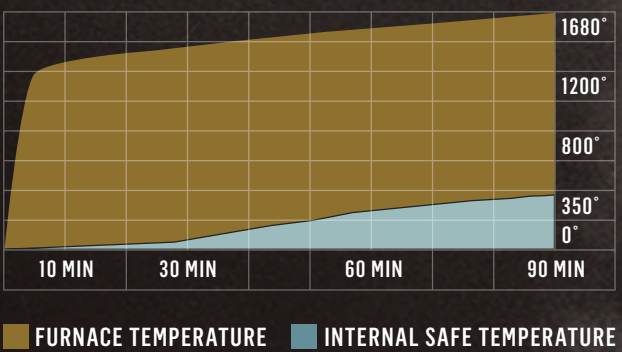

How Are the Safes Fire Tested?

Fort Knox safes are subjected to an intense house fire simulation. The safe is monitored internally by nine thermocouple sensors that are placed evenly from top to bottom as per UL72 standards. The test is terminated once the first sensor reaches 350°F, we then document the duration and external temperature to get our fire rating. The results shown are for up to 1,680°F in 90 Minutes.

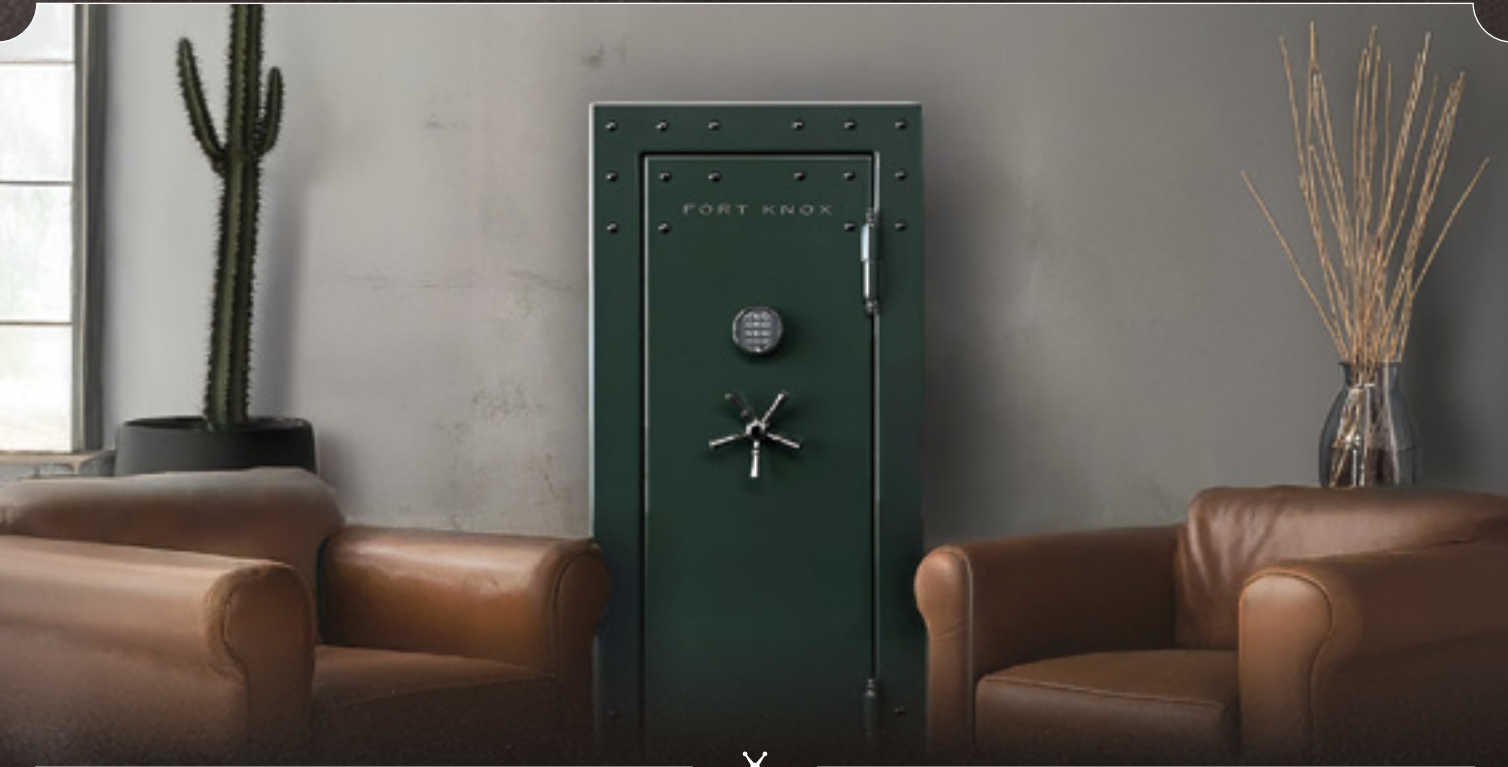

SECURITY PLATE

Fort Knox Security Plates ensure the door retains its shape, creating a resilient barrier against the encroaching flames. Intense heat will cause a thinner safe to warp, breaking the fire seal, allowing destructive flames to penetrate.

SMOKE & FIRE SEAL

There are 2 seals around the perimeter of the safe door. The Smoke Seal keeps smoke, heat, and caustic residue at bay. The Fire Seal blocks fire from entering by activating Palusol, which expands at 212°F.

THERMAL BARRIER

Thermal Barrier is a dead air gap between the outer wall and the Type-C Fireboard created by the welded anchors. This gap significantly slows down the external transfer of heat into your safe during a fire.



TYPE-C FIREBOARD

Fort Knox uses Type-C Fireboard that includes Vermiculite, a shrinkage compensating additive of blended fibers, that help maintain the structure and fire resistant properties ensuring your valuables are protected. Some manufacturers only use common drywall.

WELDED ANCHORS

Glue can melt during a fire causing fireboard to slump away from safe walls, leaving your valuables vulnerable to the flames. Fort Knox secures your fireboard using Welded Anchors to ensure the longevity and efficacy of your fire protection.



Titan, Pepperdust Finish 6637

05. UPGRADES & PACKAGES

Reinforce your Safe or Vault Door with more steel, fire-protection, & peace of mind.



SECURITY STEEL UPGRADE:

Add up to 4 layers or 1/2" of Steel

ARMAKNOX AR500 PACKAGE

ArmaKnox AR500 is made of abrasion resistant 7ga steel plates that cover all six sides of the safe. This hardened steel creates a cut, drill, and ballistic resistant barrier between your valuables and potential security breaches.

STAINLESS STEEL PACKAGE

Enhance your safe with sheets of 10ga Stainless-Steel lining all six sides, providing a cut, drill and torch resistant barrier. This upgrade delivers exceptional durability and unmatched protection for those demanding the highest level of security.



CARBON STEEL LINER

Increase the security of your safe by fortifying its walls with 10ga steel plates. Add up to four additional layers of steel, creating a significant obstacle that will waste valuable time for potential burglars.

STEEL BODY & DOOR UPGRADE

Body Upgrade: increase the steel body thickness of the safe. *Ex. 10ga up to 3/16", or 3/16" up to 1/4"*

Door Upgrade: add an additional 1/8" steel security plate to your door.

Not Available on all models/sizes.



FIRE-PROTECTION UPGRADE:

Upgrade with RFL for the Ultimate Fire Protection

REINFORCED FIRE LINER



UP TO 1680F IN
120 MINUTES

Upgrade your fire protection by adding additional layers of Type-C fireboard to all six sides of your safe for up to 2 hours of fire protection.

Adding RFL Reduces Gun Capacity, RFL not available on Maverick or Spartan Models

BODY DEPTH UPGRADE:

Increase your storage capacity with added 9" of depth!

EXTRA-DEEP UPGRADE



INCREASE OVERALL
DEPTH TO 40"

Upgrade the box depth of your safe from 27" to 40"! The XD upgraded safe may not be able to fit through a standard door frame.

XD upgrade only available on sizes: 7251 and 7261

06. EXTERIOR COLORS

Choose from Our Range of Premium Paint Finishes, & Detail Options to Find Your Perfect Match

TEXTURED PAINT FINISH:



DARK GRANITE LIGHT GRANITE RIMROCK

PREMIUM UPGRADES:



DISTRESSED
Rivet Trim Included **TWO-TONE**
External Hinge Only **FADE**
Select 2 Colors **RIVET TRIM**
Specify Rivet Color **CRANE HINGE**
Cut-Out Lettering

HIGH GLOSS PAINT FINISH:

**Representation of color is not exact, appearance will vary*



PLATINUM CEMENT COOL GREY SKY BLUE MERCEDES SILVER MIDNIGHT BLUE BURGUNDY WINE BLACK CHERRY



BRILLIANT WHITE CHAMPAGNE DUNE ROOT BEER BROWN PEPPERDUST ARMY GREEN FOREST GREEN JET BLACK

07. LOCKS & GRAPHICS

LOCK OPTIONS:



MECHANICAL

- Reliable Key and Combo Entry
- EMP Proof

AVAILABLE COLORS:

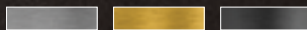

ELECTRONIC

- Quick Access
- EMP Resistant

AVAILABLE COLORS:

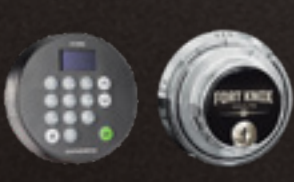
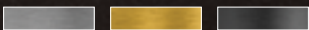

REDUNDANT

- Quick Access
- EMP Proof

KEYPAD:

DIAL:



BIOMETRIC

- Quick Access Fingerprint Entry
- Lock Manufacturer Warranty

AVAILABLE COLOR:

DETAIL OPTIONS:



GOLD



BLACK CHROME



CHROME

GRAPHIC OPTIONS: *Pinstripe, the vinyl stripe connecting corner decals, is not available on texture finish.*



LOGO ONLY

*Spartan | Maverick
Included*



TRADITIONAL

*Defender | Protector | Executive
Included*



CLASSIC

*Guardian | Titan | Legend
Included*



DOUBLE DIAMOND

*External Right-Swing Hinge
Graphic Upgrade*



PERFORMANCE

*Internal Right-Swing Hinge
Graphic Upgrade*

08. INTERIOR OPTIONS

FABRIC OPTIONS:



INTERIOR LAYOUT OPTIONS:

UNIVERSAL

- 6026: 4 SHELVES
- 6031: 4 SHELVES
- 6637: 5 SHELVES
- 7241: 5 SHELVES
- 7251: 5 SHELVES
- 7261: 5 SHELVES
- 7251XD: 5 SHELVES
- 7261XD: 5 SHELVES

UNIVERSAL WITH GUNS

- 6026: 3 GUNS
- 6031: 4 GUNS
- 6637: 4 GUNS
- 7241: 4 GUNS
- 7251: 4 GUNS
- 7261: 4 GUNS
- 7251XD: 4 GUNS
- 7261XD: 4 GUNS

1/4 GUN RACK

- 6026: N/A
- 6031: 8 GUNS
- 6637: 8 GUNS
- 7241: 12 GUNS
- 7251: 12 GUNS
- 7261: 12 GUNS
- 7251XD: 18 GUNS
- 7261XD: 18 GUNS

1/2 EZ GUN RACK

- 6026: N/A
- 6031: 13 GUNS
- 6637: 14 GUNS
- 7241: 15 GUNS
- 7251: 18 GUNS
- 7261: 21 GUNS
- 7251XD: 26 GUNS
- 7261XD: 28 GUNS

1/2 GUN RACK

- 6026: 8 GUNS
- 6031: 18 GUNS
- 6637: 22 GUNS
- 7241: 26 GUNS
- 7251: 34 GUNS
- 7261: 42 GUNS
- 7251XD: 51 GUNS
- 7261XD: 63 GUNS

3/4 GUN RACK

- 6026: N/A
- 6031: 26 GUNS
- 6637: 30 GUNS
- 7241: 38 GUNS
- 7251: 46 GUNS
- 7261: 54 GUNS
- 7251XD: 69 GUNS
- 7261XD: 81 GUNS

ALL GUN RACK

- 6026: 16 GUNS
- 6031: 36 GUNS
- 6637: 44 GUNS
- 7241: 52 GUNS
- 7251: 68 GUNS
- 7261: 84 GUNS
- 7251XD: 102 GUNS
- 7261XD: 126 GUNS

GUN COLLECTOR

- 6026: 18 GUNS
- 6031: 40 GUNS
- 6637: 48 GUNS
- 7241: 57 GUNS
- 7251: 73 GUNS
- 7261: 100 GUNS
- 7251XD: 110 GUNS
- 7261XD: 150 GUNS

CABINET

- ONLY AVAILABLE WITH EXTERNAL HINGE.
- CABINET DIMENSIONS AND GUN RACK VARY BY SAFE SIZE.
- FILE DRAWER OPTION AVAILABLE.



09. ACCESSORIES



Shop Accessories

INTERIOR ACCESSORIES:

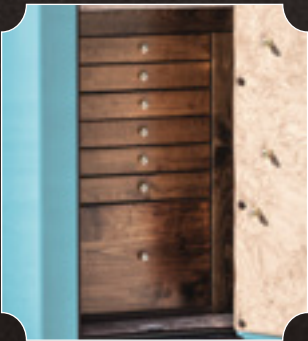

CABINET



CARPETED PEDESTAL



PULL HANDLE



LED LIGHT SYSTEM

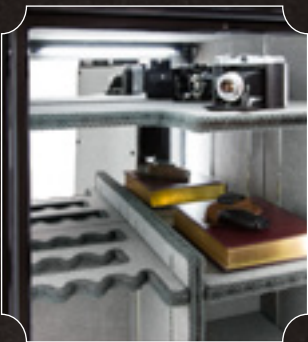

MIRROR



DEHUMIDIFIER



DOOR HOLSTER



DOOR ORGANIZER

BUNDLE PACKAGES

Customizing your safe is now more convenient than ever. We've combined our most popular accessories into cost-saving bundles. Simply choose the "Bundle" option in the Accessories tab of our Vault Builder to get started.

SPARTAN | MAVERICK

LED LIGHTS	PULL HANDLE
DOOR ORGANIZER	DEHUMIDIFIER

DEFENDER | PROTECTOR | EXECUTIVE

LED LIGHTS	PULL HANDLE
CORNER BOLTS	DEHUMIDIFIER

* Bundle packages vary based on Size and Model. Sizes 4026/6026 Bundle Include Lights, Dehumidifier, & Door Upgrade

10. SECURITY BOXES



Shop Pistol Boxes

ORIGINAL PISTOL BOX

- **CONSTRUCTION:** 10GA BODY, 3/16" DOOR
- **EXTERNAL DIMENSIONS:** 10.25"D X 12.5"W X 4.35"H
- **INTERNAL DIMENSIONS:** 9.75"D X 11.75"W X 3.5"H
- **MECHANICAL LOCK:** QUICK-ACCESS PUSH BUTTON
- **WEIGHT:** 22LBS
- **FEATURES:** MOUNTING HOLES, REMOVABLE FOAM PAD FOR ADDITIONAL INTERNAL SPACE



AUTO, PERSONAL & SHOTGUN BOX

- **CONSTRUCTION:** 10GA BODY, 3/16" DOOR
- **MECHANICAL LOCK:** QUICK-ACCESS PUSH BUTTON
- **FEATURES:** MOUNTING HOLES

AUTO EXTERNAL DIMENSIONS: 6"D X 9.5"W X 5"H
• INT. DIMENSIONS: 4.75"D X 8.5"W X 4"H | **13LBS**
PERSONAL EXTERNAL DIMENSIONS: 12"D X 9.5"W X 5"H
• INT. DIMENSIONS: 10.5"D X 8.5"W X 4"H | **20LBS**
SHOTGUN EXTERNAL DIMENSIONS: 45"D X 9.5"W X 5"H
• INT. DIMENSIONS: 42"D X 8.5"W X 4"H | **54LBS**



CONTROLLED ACCESS BOX

The Controlled-Access-Box (CAB) is our biggest security box, designed for standalone use or to enhance security within your safe.

- **CAB20:** 13"L X 20"W X 8"H | **43LBS**
CAB20 FITS ON TOP OF 6026, OR INSIDE 6026
- **CAB24:** 15"L X 24"W X 8"H | **55LBS**
CAB24 FITS ON TOP OF 6026, OR INSIDE 6031
- **CAB28:** 15"L X 28"W X 8"H | **63LBS**
CAB28 FITS ON TOP OF 6031, OR INSIDE 6637



Limited Lifetime Warranty on All Pistol Boxes

✱ ✱ ✱ ✱ ✱
PROUDLY CRAFTED IN THE

Burgundy Wine, 8248 Vault Door

Pepperdust, 8240 Vault Door

Distressed 7261 with Crane-Hinge

Brilliant White, 6637

Army Green with Rivet Trim

Rimrock to Black, 2-Tone

Black Cherry, with Crane-Hinge

Jet Black 6031, with Mirror

Midnight Blue 4026

Brilliant White, 4026

New 6031, Home Safe

UNITED STATES OF AMERICA

✱ ✱ ✱ ✱ ✱

SPARTAN SAFE



3/16"
OVERALL BODY STEEL THICKNESS



Dark Granite Texture Finish

HINGE External Only

PULL HANDLE [Bundle](#)

LIGHTS [Bundle](#)

DEHUMIDIFIER [Bundle](#)

DOOR ORGANIZER [Bundle](#)

LIMITED LIFETIME WARRANTY [Included](#)

Size	Depth	Volume	Weight	Bolts
4026	20"/22"	10 ft³	566 Lbs.	12
6026	20"/22"	16 ft³	756 Lbs.	12
6031	27"/29"	28 ft³	983 Lbs.	12
6637	27"/29"	36 ft³	1,168 Lbs.	12
7241	27"/29"	45 ft³	1,333 Lbs.	14
7251	27"/29"	57 ft³	1,496 Lbs.	14
7261	27"/29"	69 ft³	1,616 Lbs.	14



DEFENDER SAFE



10GA
OVERALL BODY STEEL THICKNESS



White Finish, Performance Stripe

DOOR ORGANIZER [Included](#)

CORNER BOLTS [Bundle](#)

LIGHTS [Bundle](#)

DEHUMIDIFIER [Bundle](#)

PULL HANDLE [Bundle](#)

LIMITED LIFETIME WARRANTY [Included](#)

Size	Depth	Volume	Weight	Bolts
4026	20"/23"	10 ft³	516 Lbs.	11
6026	20"/23"	16 ft³	711 Lbs.	11
6031	27"/30"	28 ft³	903 Lbs.	11
6637	27"/30"	36 ft³	1,133 Lbs.	11
7241	27"/30"	45 ft³	1,373 Lbs.	13
7251	27"/30"	57 ft³	1,763 Lbs.	13
7261	27"/30"	69 ft³	1,848 Lbs.	13



MAVERICK SAFE



10GA
OVERALL BODY STEEL THICKNESS

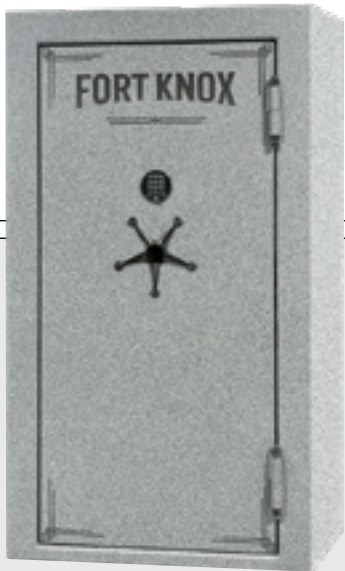

Light Granite Finish
Double Diamond Graphics

HINGE External Only

PULL HANDLE [Bundle](#)

LIGHTS [Bundle](#)

DEHUMIDIFIER [Bundle](#)

DOOR ORGANIZER [Bundle](#)

LIMITED LIFETIME WARRANTY [Included](#)

Size	Depth	Volume	Weight	Bolts
4024	18"/21"	8 ft³	436 Lbs.	9
6024	18"/21"	14 ft³	586 Lbs.	9
6026	20"/23"	16 ft³	626 Lbs.	9
6031	27"/30"	28 ft³	813 Lbs.	9
6041	27"/30"	32 ft³	998 Lbs.	9
6637	27"/30"	36 ft³	1,008 Lbs.	9
7241	27"/30"	45 ft³	1,133 Lbs.	11
7251	27"/30"	57 ft³	1,328 Lbs.	13
7261	27"/30"	69 ft³	1,468 Lbs.	13

PROTECTOR SAFE



3/16"
OVERALL BODY STEEL THICKNESS



Dark Granite & Crane-hinge

HINGE CAPS [Included](#)

PULL HANDLE [Bundle](#)

LIGHTS [Bundle](#)

DEHUMIDIFIER [Bundle](#)

CORNER BOLTS [Bundle](#)

LIMITED LIFETIME WARRANTY [Included](#)

Size	Depth	Volume	Weight	Bolts
4026	20"/23"	10 ft³	576 Lbs.	11
6026	20"/23"	16 ft³	791 Lbs.	11
6031	27"/30"	28 ft³	988 Lbs.	11
6637	27"/30"	36 ft³	1,248 Lbs.	11
7241	27"/30"	45 ft³	1,503 Lbs.	13
7251	27"/30"	57 ft³	1,763 Lbs.	13
7261	27"/30"	69 ft³	1,848 Lbs.	13

EXECUTIVE SAFE



Cement Finish

DOOR ORGANIZER.....	Included
CORNER BOLTS.....	Bundle
LIGHTS.....	Bundle
DEHUMIDIFIER.....	Bundle
PULL HANDLE.....	Bundle
LIMITED LIFETIME WARRANTY.....	Included

Size	Depth	Volume	Weight	Bolts
4026	20"/23"	10 ft³	656 Lbs.	11
6026	20"/23"	16 ft³	891 Lbs.	11
6031	27"/30"	28 ft³	1,119 Lbs.	11
6637	27"/30"	36 ft³	1,368 Lbs.	11
7241	27"/30"	45 ft³	1,668 Lbs.	13
7251	27"/30"	57 ft³	1,898 Lbs.	13
7261	27"/30"	69 ft³	2,058 Lbs.	13



TITAN SAFE



Distressed Finish with Crane-hinge

AR500 STEEL LINER.....	Included
PULL HANDLE.....	Optional
LIGHTS.....	Included
DEHUMIDIFIER.....	Included
CORNER BOLTS.....	Included
LIMITED LIFETIME WARRANTY.....	Included

Size	Depth	Volume	Weight	Bolts
6031	27"/30"	28 ft³	1,463 Lbs.	18
6637	27"/30"	36 ft³	1,818 Lbs.	20
7241	27"/30"	45 ft³	2,168 Lbs.	20
7251	27"/30"	57 ft³	2,596 Lbs.	20
7261	27"/30"	69 ft³	2,771 Lbs.	20



GUARDIAN SAFE

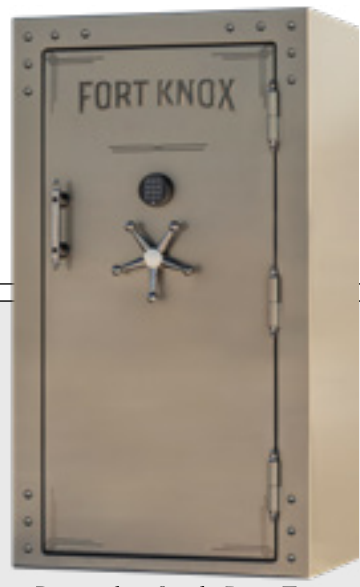
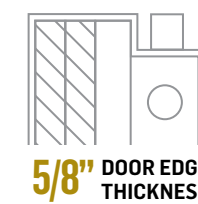

Pepperdust finish, Rivet Trim

INNER STEEL LINER 10GA.....	Included
PULL HANDLE.....	Optional
LIGHTS.....	Included
DEHUMIDIFIER.....	Optional
CORNER BOLTS.....	Included
LIMITED LIFETIME WARRANTY.....	Included

Size	Depth	Volume	Weight	Bolts
6031	27"/30"	28 ft³	1,253 Lbs.	18
6637	27"/30"	36 ft³	1,583 Lbs.	20
7241	27"/30"	45 ft³	1,888 Lbs.	20
7251	27"/30"	57 ft³	2,138 Lbs.	20
7261	27"/30"	69 ft³	2,288 Lbs.	20

LEGEND SAFE



Brilliant White Finish
& Double Diamond Graphics

AR500 STEEL LINER.....	3/16"
STAINLESS STEEL LINER.....	10GA
NICKEL PLATED GEARS.....	Included
LIGHTS.....	Included
CORNER BOLTS.....	Included
LIMITED LIFETIME WARRANTY.....	Included

Size	Depth	Volume	Weight	Bolts
6637	27"/30"	36 ft³	2,262 Lbs.	26
7241	27"/30"	45 ft³	2,681 Lbs.	28
7251	27"/30"	57 ft³	2,993 Lbs.	28
7261	27"/30"	69 ft³	3,253 Lbs.	28

HOME SAFES



1/2" DOOR EDGE THICKNESS



LOCKING BOLTS



**FIRE RATING:
1680°F IN 120 MIN**

3/16"

OVERALL BODY STEEL THICKNESS



*New 6031 Home Safe,
Sky Blue Finish*

CABINET.....Included
FELT DRAWER INSERTS.....Included
HINGE.....External Only
LIGHTS.....Included
DEHUMIDIFIER.....Optional
JEWELRY BACK PANEL.....Included
FIRE PROTECTION.....RFL Included
LIMITED LIFETIME WARRANTY.....Included

Model	Liners	Depth	Volume	Weight	Bolts
Marquise 4026	N/A	20"/23"	10ft³	699 Lbs.	11
Marquise 6026	N/A	20"/23"	16ft³	914 Lbs.	11
Marquise 6031	N/A	27"/30"	28 ft³	1,253 Lbs.	11
Legacy 4026	AR500 Steel	20"/23"	10ft³	912 Lbs.	11
Legacy 6026	AR500 Steel	20"/23"	16ft³	1,209 Lbs.	11
Legacy 6031	AR500 Steel	27"/30"	28 ft³	1,655 Lbs.	11
Treasury 4026	AR500 + Stainless	20"/23"	10ft³	1,049 Lbs.	11
Treasury 6026	AR500 + Stainless	20"/23"	16ft³	1,408 Lbs.	11
Treasury 6031	AR500 + Stainless	27"/30"	28 ft³	1,918 Lbs.	11



VAULT DOOR: IN OR OUT-SWING



5/8" DOOR EDGE THICKNESS



LOCKING BOLTS



**FIRE RATING:
N/A**

3/16"

FACE FRAME THICKNESS



*Distressed Finish, In-Swing with
Left-Swing Faux Crane-Hinge*

AR500 STEEL.....Optional
STAINLESS STEEL.....Optional
PULL HANDLE.....Included
HINGE PLACEMENT.....Left or Right
SWING.....In or Out
LIMITED LIFETIME WARRANTY.....Included

VAULT DOOR SPECS				
Size	Rough Opening	H x W INCLUDING FRAME	Weight	Bolts
8240	82"x 40"	85"x 45"	1,310 Lbs.	19 IN/24OUT
8248	82"x 48"	85"x 56"	1,580 Lbs.	19 IN/24OUT
9640	96"x 40"	99" x 45"	1,525 Lbs.	23 IN/26OUT
9648	96"x 48"	99" x 56"	1,840 Lbs.	23 IN/26OUT

VAULT DOOR FAQ'S

ATTENTION: Accurate measurements of the rough opening, wall thickness, and face frame clearance are the customer's responsibility to ensure a secure fit and maximum protection. *Replacement parts due to incorrect measurements will incur additional charges.*

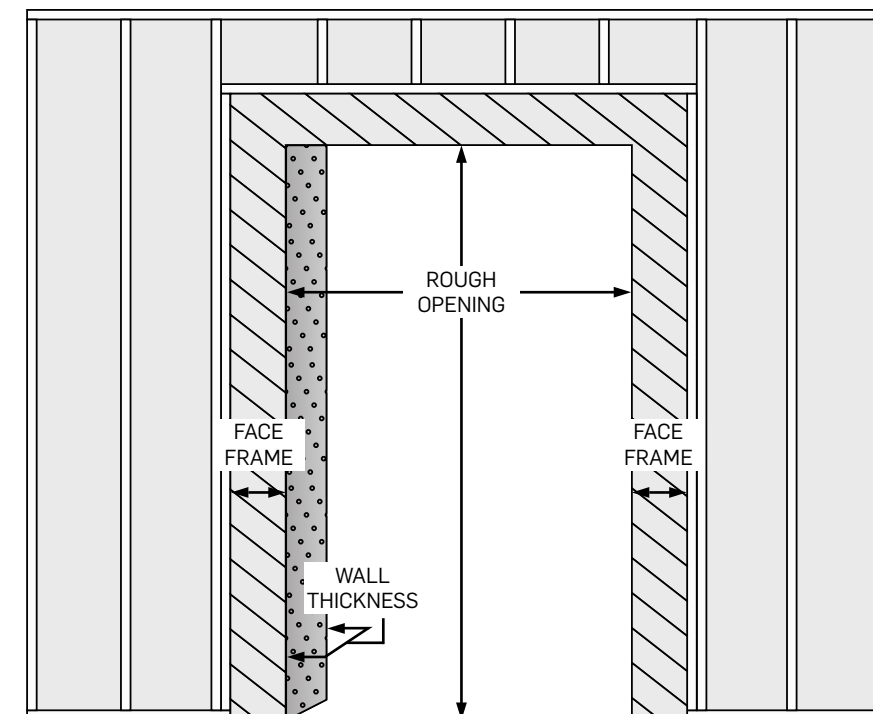

ROUGH OPENINGS MEASUREMENTS

Size	HEIGHT	WIDTH
8240	82"	40"
8248	82"	48"
9640	96"	40"
9648	96"	48"

OUT-SWING HINGES

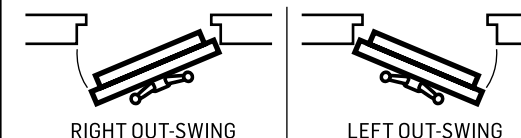

IN-SWING HINGES

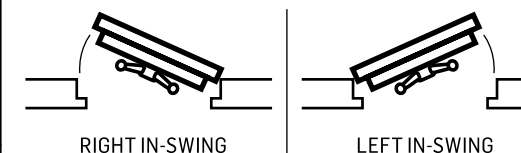

1. ROUGH OPENING

Measure Height & Width of the Rough Opening.
For Maximum Security and Fire Protection mount door directly to concrete wall.
Remove wood framing and imperfections, leave smooth concrete only.

2. WALL THICKNESS

Measure the wall thickness of concrete alone.
Measure in 3 places to ensure accuracy.
Generally measurement will be between 6-12"
Round measurement to nearest inch.

3. FACE FRAME

Vault Door frame will clamp directly to concrete.
Leave at least 4" clearance around rough opening.
Clear both sides of rough opening, inside and out.

4. IN-SWING VS OUT-SWING

The In-Swing door (internal hinge) ensures functionality if blocked from the outside, ideal for storm shelters or panic rooms.
Out-Swing (external hinge) offers 180° door swing radius which benefits those with limited vault room space.
For maximum security and fire protection clamp the Vault Door frame directly to the concrete.
Custom sizes available



VAULT DOOR INSTALLATION:
Scan to Watch

BUILD YOURS TODAY

AT FTKNOX.COM



SAFE MODEL	SPARTAN	MAVERICK	DEFENDER	PROTECTOR	EXECUTIVE	GUARDIAN	TITAN	LEGEND	HOME SAFES	VAULT DOOR IN-SWING	VAULT DOOR OUT-SWING
FIRE PROTECTION	1,200° F In 60 Minutes	1,200° F In 75 Minutes	1,680° F In 90 Minutes	1,680° F In 90 Minutes	1,680° F In 90 Minutes	1,680° F In 90 Minutes	1,680° F In 90 Minutes	1,680° F In 90 Minutes	1,680° F In 120 Minutes	N/A	N/A
OVERALL BODY STEEL THICKNESS	3/16"	10GA	10GA	3/16"	1/4"	5/16"	3/8"	1/2"	3/16"	3/16"	3/16"
DOOR EDGE STEEL THICKNESS	3/8"	3/8"	1/2"	1/2"	5/8"	5/8"	3/4"	1"	1/2"	5/8"	5/8"
LOCKING BOLTS	12	9	11	11	11	18	18	26	11	19	24
STAINLESS STEEL LINER	N/A	Optional	Optional	Optional	Optional	Optional	Optional	Included	Optional	Optional	Optional
AR500 STEEL LINER	N/A	Optional	Optional	Optional	Optional	Optional	Included	Included	Optional	Optional	Optional
CARBON STEEL LINER	Optional	Optional	Optional	Optional	Optional	10GA	Optional	Optional	Optional	Optional	Optional
CORNER BOLTS	N/A	N/A	Bundle	Bundle	Bundle	Included	Included	Included	N/A	N/A	Included
DOOR ORGANIZER	Bundle	Bundle	Included	Included	Included	Included	Included	N/A	Mirror/Jewelry Hangers	N/A	N/A
LIGHTS	Bundle	Bundle	Bundle	Bundle	Bundle	Included	Included	Included	Included	N/A	N/A
DEHUMIDIFIER	Bundle	Bundle	Bundle	Bundle	Bundle	Optional	Included	Included	Optional	N/A	N/A
PULL HANDLE	Bundle	Bundle	Bundle	Bundle	Bundle	Optional	Optional	Optional	Optional	Included	Included
HINGE CAPS	Included	Included	Included	Included	Included	Included	Included	Included	Included	Included	Included
LIMITED LIFETIME WARRANTY	Included	Included	Included	Included	Included	Included	Included	Included	Included	Included	Included



SCAN & BUILD

800.821.5216 | FTKNOX.COM

Copyright 2025 Fort Knox Inc. All Rights Reserved